

ITEM NO.	PartNo	DESCRIPTION	QTY.
1	71517	Double Bearing Support	1
2	30449	No 4 SAE Washer	4
3	71505	1/8"ID x 3/8"OD x 0.156"W Plastic Bearing	2
4	30610	5-40 x 1/2"L Phillip Pan Head Screw	1
5	30166	5-40 Nylon Lock Nut Stainless Steel	5
6	71518	Double Bearing Cover	1
7	29951	1/8"Dia x 7/8"L Plastic Dowel Pin	2
8	30613	5-40 x 3/4"L Phillip Pan Head Screw	3

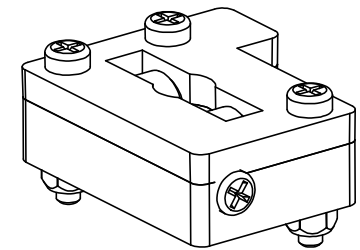

NOTE:

1. Make two assemblies.
2. Assemble Item 8 from top direction on one assembly and from bottom on other assembly.

PROJECT:		
SeeMeCNC H-1		
TITLE:		
Double Bearing Sub Assembly		
SIZE	DWG. NO.	REV
A	71578	1
©2012 SeeMeCNC™		

5

↑

4

3

2

1